

WINDVEST INSTRUCTION SHEET

CONTENTS
6 ALLEN BOLTS
2 BOTTOM CLAMPS
2 TOP CLAMPS
1 WINDVEST ASSY
1 3/16" ALLEN WRENCH

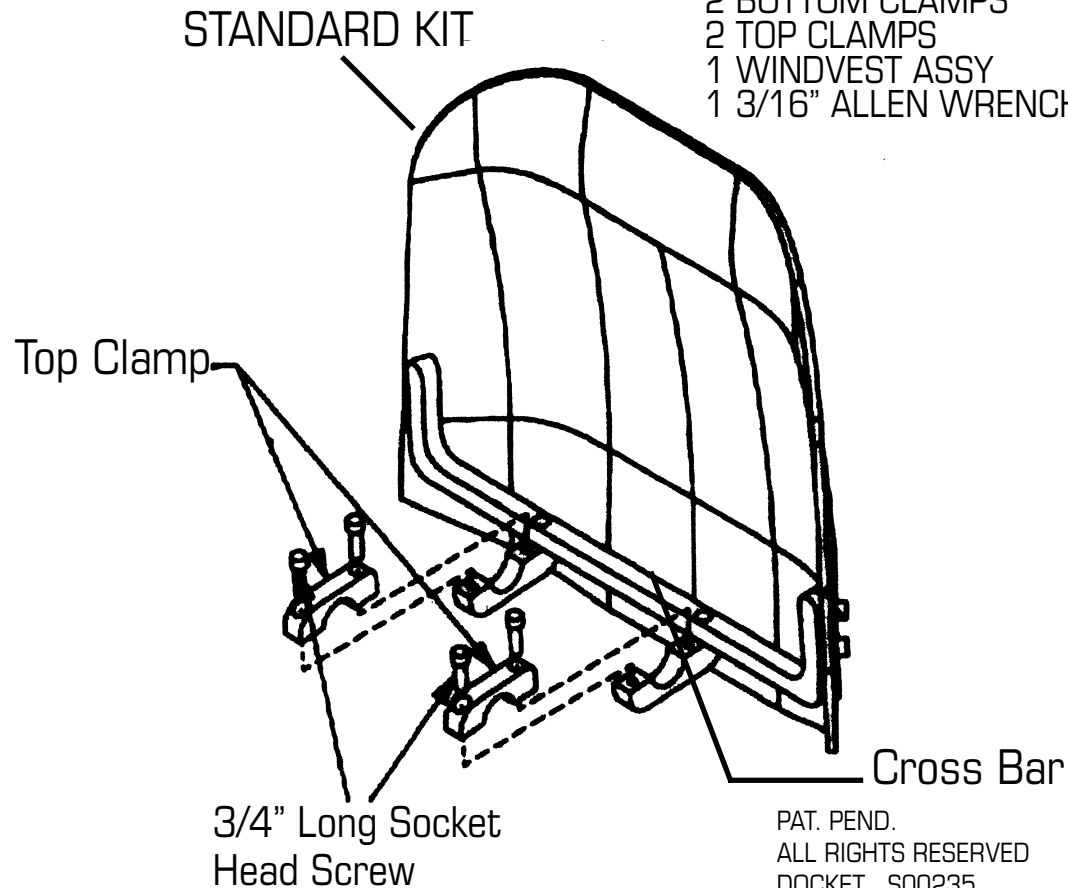
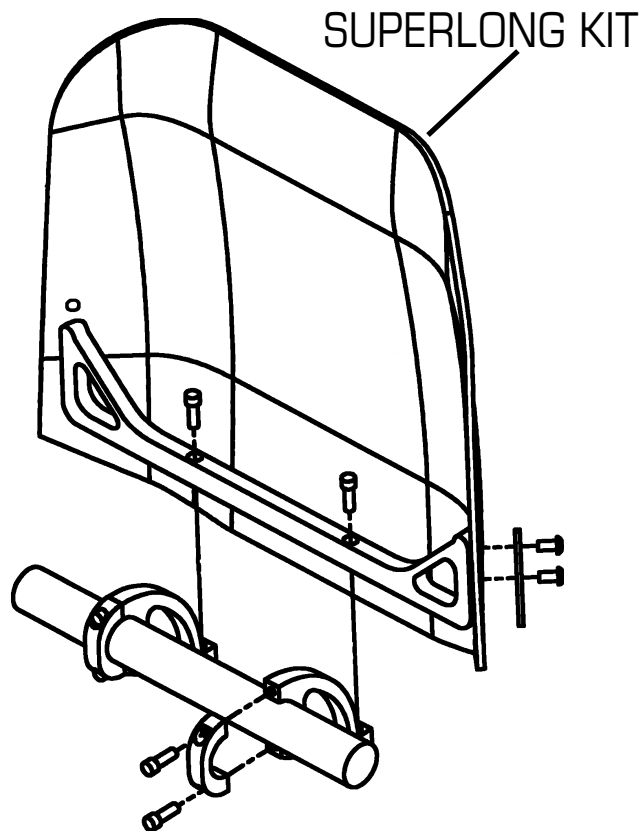

ASSEMBLY INSTRUCTIONS:

- 1) Install clamps to handlebar.
(DO NOT TIGHTEN YET)
- 2) Install Windvest Assembly to clamps using 1/4 x 20 x 3/4 Socket head screws.
- 3) Snug down screws in cross bar.
- 4) Adjust tilt to desired angle and tighten clamp screws.
- 5) Retorque all screws evenly to make sure they are tight.

HELPFUL HINTS:

- 1) Check for obstructions (ie. wires, etc.)
- 2) Cover the fuel tank to protect it from falling objects such as tools.
- 3) Make sure the gap between the top and bottom clamps is even as possible.
- 4) For cleaning use SOFT CLOTH with mild soap or plastic cleaners only. Wax occasionally.
- 5) To raise windscreen 1 inch use holes under front cover plates. (NOT SHOWN)
- 6) Quick release - remove two cross bar bolts.

PAT. PEND.
ALL RIGHTS RESERVED
DOCKET .S00235

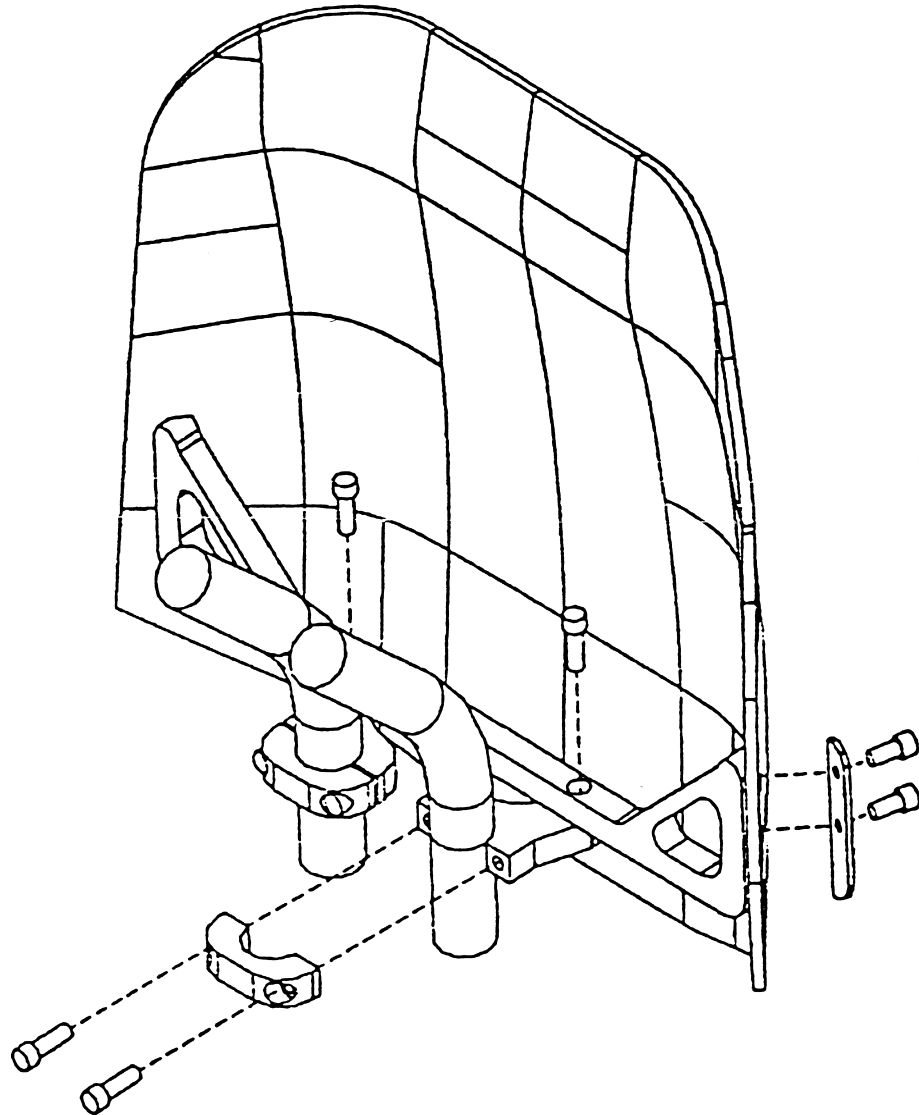

Swivel Clamp Instructions

1. Bolt Swivel clamps to risers as shown
 2. Bolt limiter bar to clamps (snug, do not tighten yet)
 3. Center unit to bars, check alignments, tighten all bolts
- Refer to standard instructions for more detail and helpful hints

Tech Support: **TOLL FREE 877-370-7326**
www.windvest.com